

Security \propto Simplicity

WAFERLOCK eKey APP Operation Manual



Download APP



Andriod



iOS



Registration

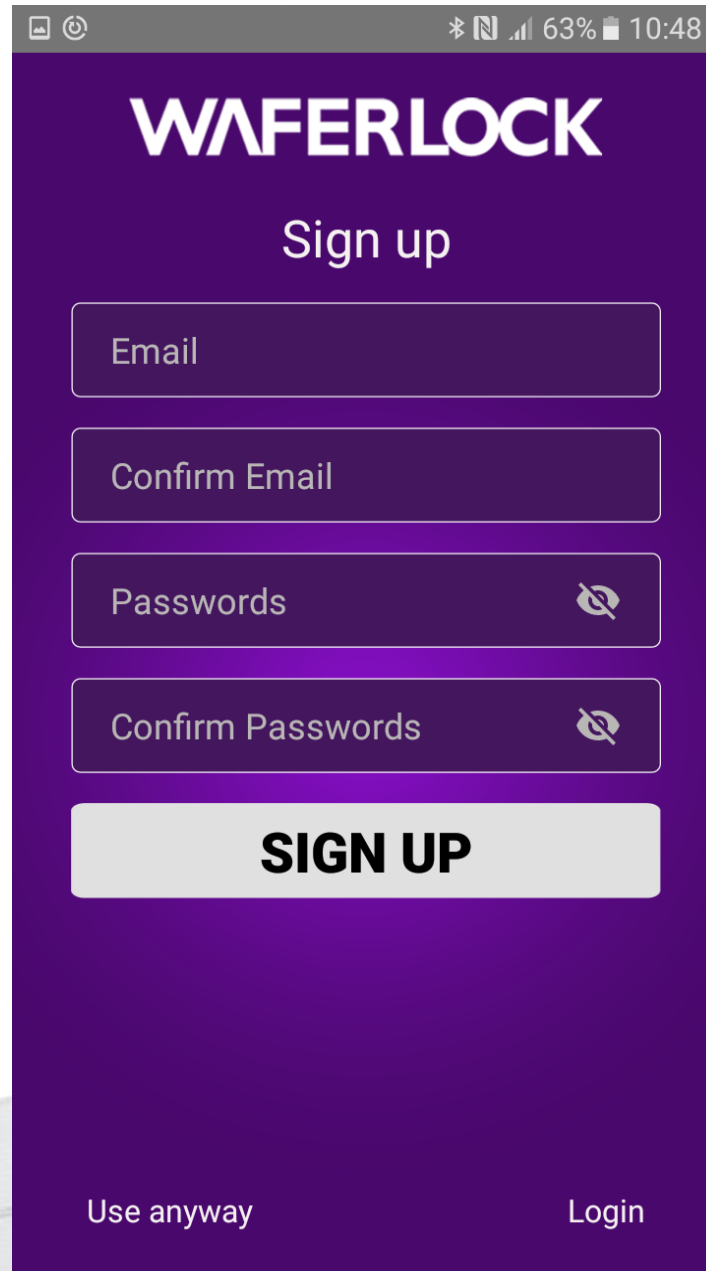



WAFERLOCK

Sign up

Email

Confirm Email

Passwords 

Confirm Passwords 

SIGN UP

Use anyway Login

Register with email and password



*** After receiving the verification mail,
please click the link and user can login
with the registered account**

➔ Login directly with the registered account

Login

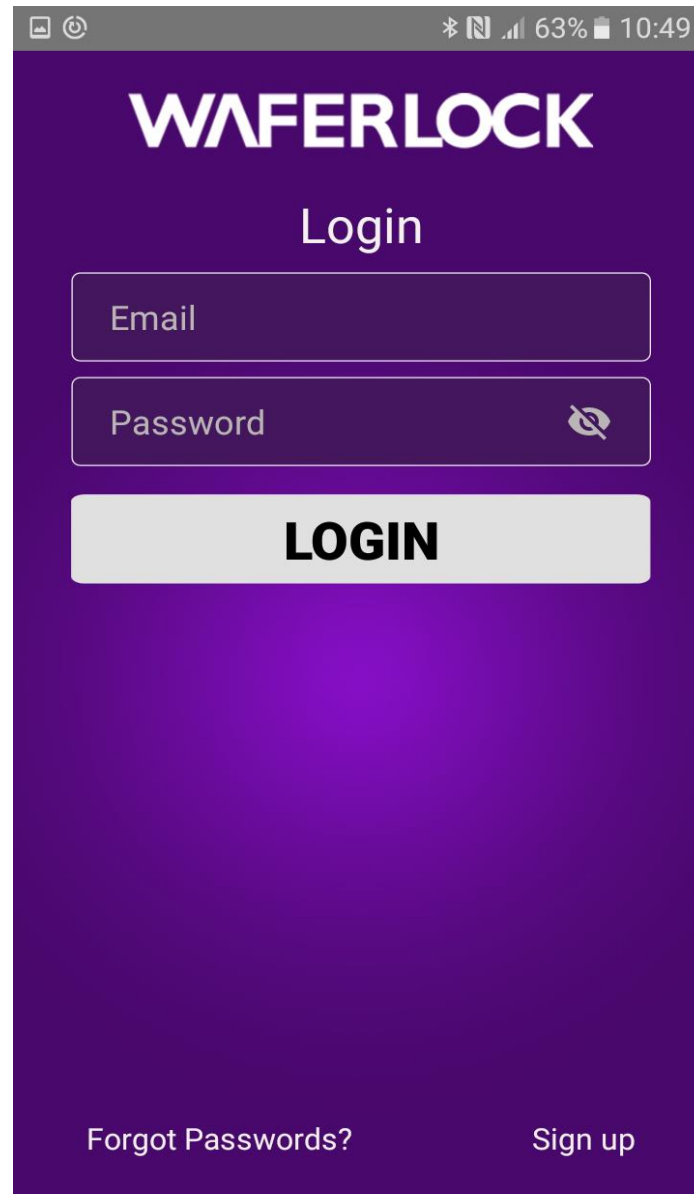

The image shows a mobile application interface for WAFERLOCK. At the top, there is a status bar with icons for signal, battery (63%), and time (10:49). Below this, the WAFERLOCK logo is displayed in white on a dark purple background. Under the logo, the word "Login" is centered. There are two input fields: "Email" and "Password". The "Password" field has a toggle icon (an eye with a slash) to its right. Below the input fields is a large, light gray button with the word "LOGIN" in bold black letters. At the bottom of the screen, there are two links: "Forgot Passwords?" and "Sign up".

WAFERLOCK

Login

Email

Password

LOGIN

[Forgot Passwords?](#) [Sign up](#)

Login the account for push notification

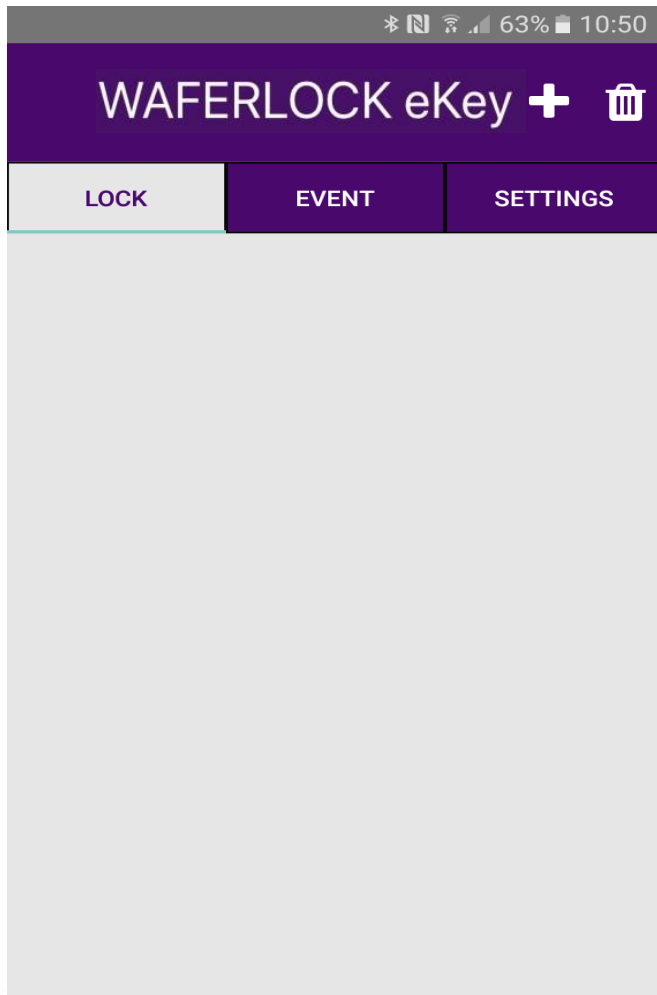

Main Screen (Not yet paired a lock)



 Click to add lock

 Delete virtual key
(Unable to unpair Master Phone or User Phone)

After Pairing

	C702 Invalid		First paired phone will be Master Phone
	C702 Invalid		User Phone
	L343 . Invalid		Virtual Key Phone

Add Lock

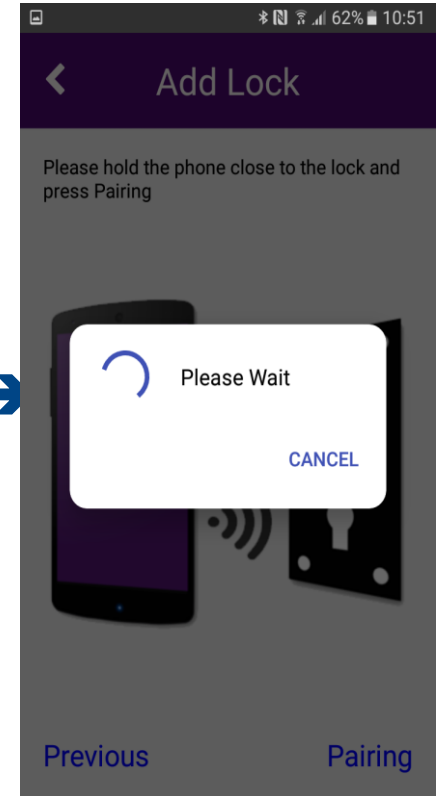
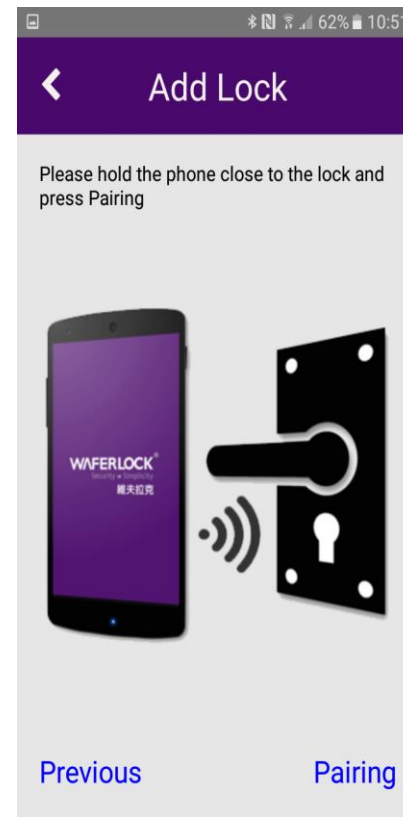
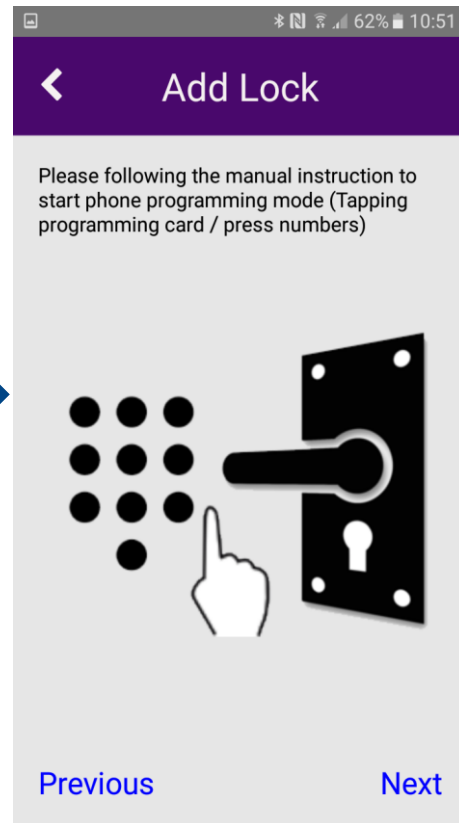
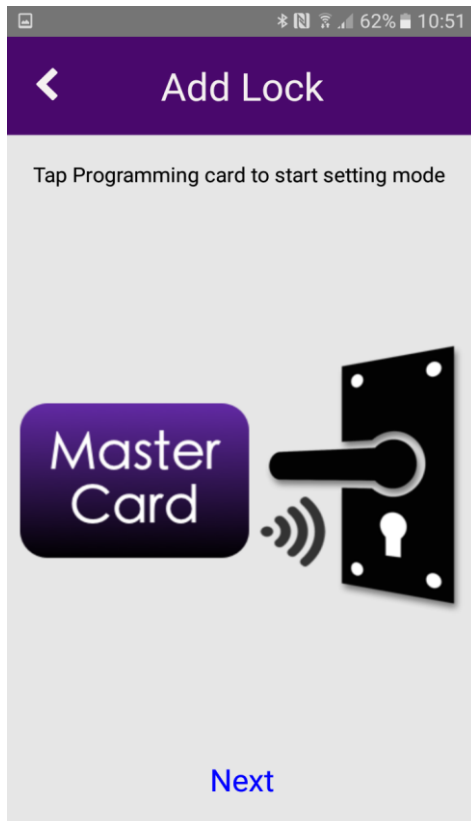

Present programming card 5 second to enter the pairing mode

Beep x3 (Bi·Bi·Bi)

. 5 seconds

Long Beep x1 (Bi---

or specify on the user manual

Then press pairing button

Add Lock

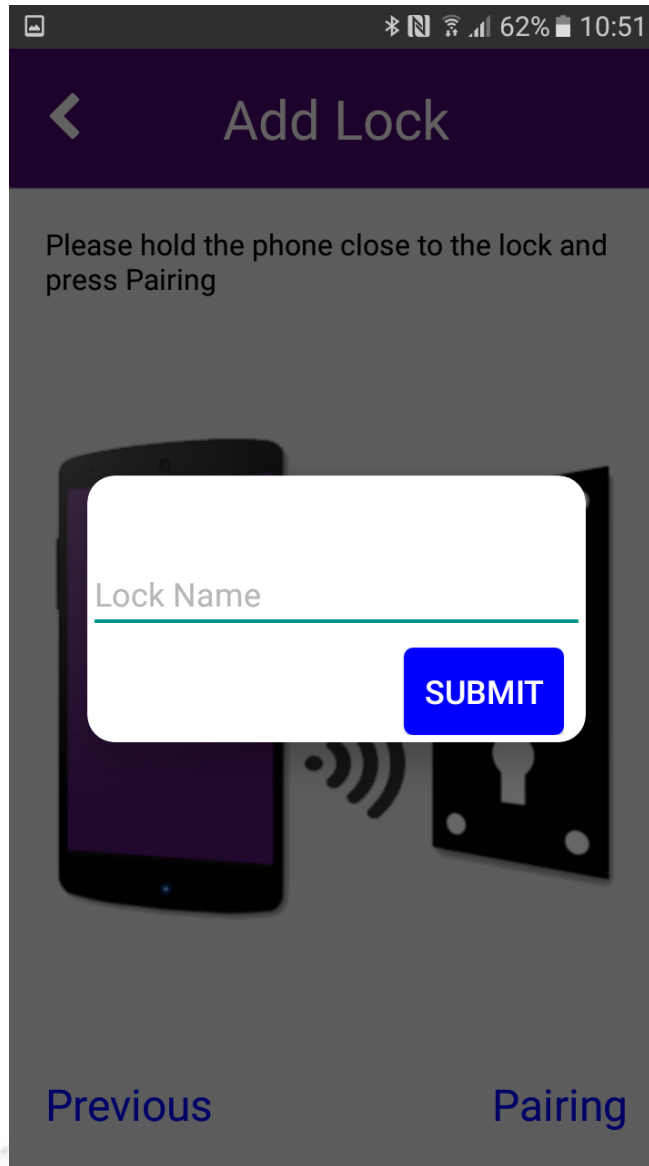
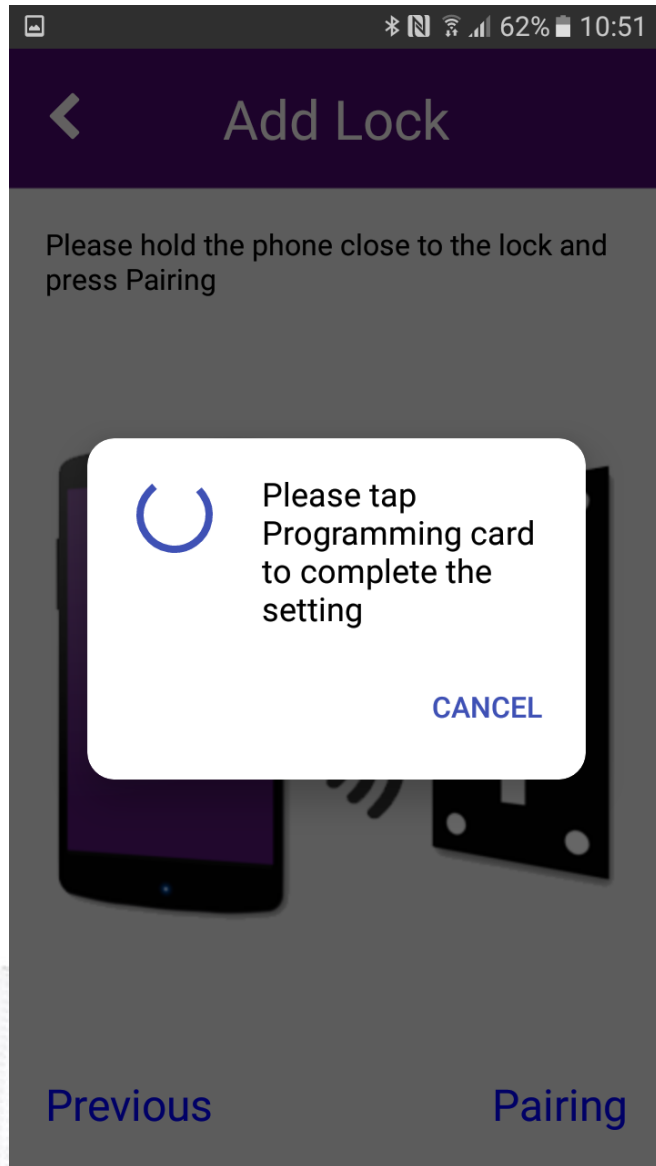

Present programming card again to complete the setting

First paired phone will be master phone

→ **Receive push notification.**

→ **Manage virtual key**

※ Repeat the procedure if pairing failed

Main Screen (Lock paired)

Master Phone

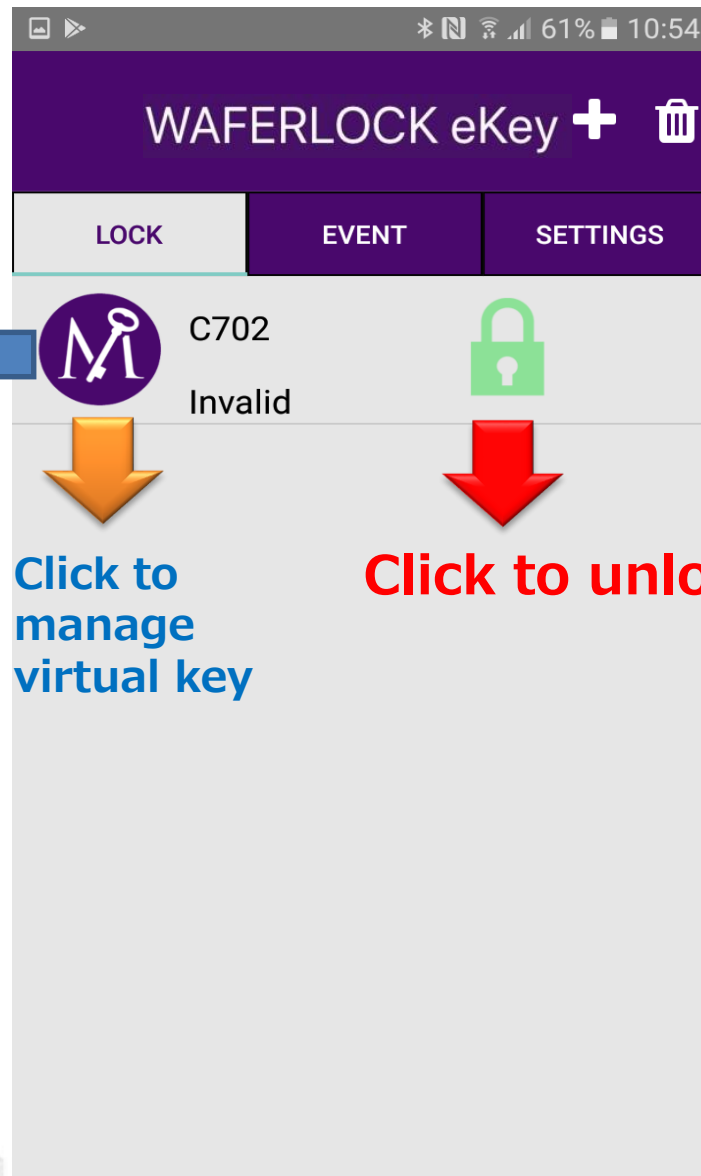

Click to add more locks



Unlock event by virtual key and main operation phone itself

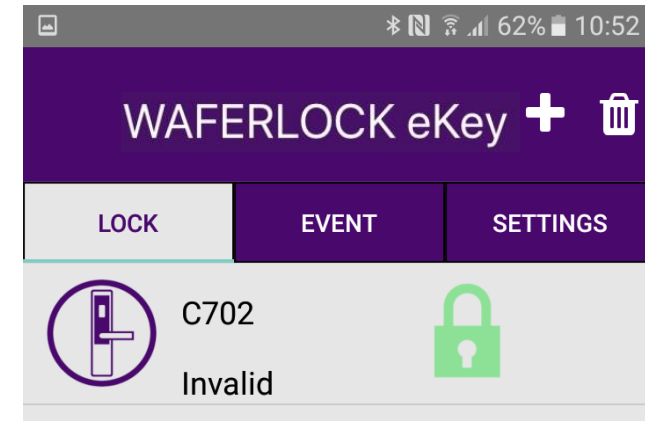

Normal User Phone

Time Synchronization ★IMPORTANT

★ Sync time to ensure the virtual key working period is correct

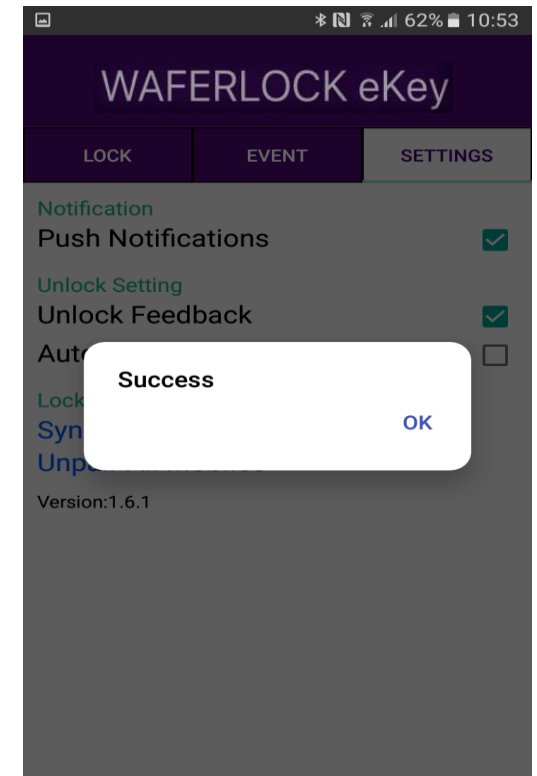
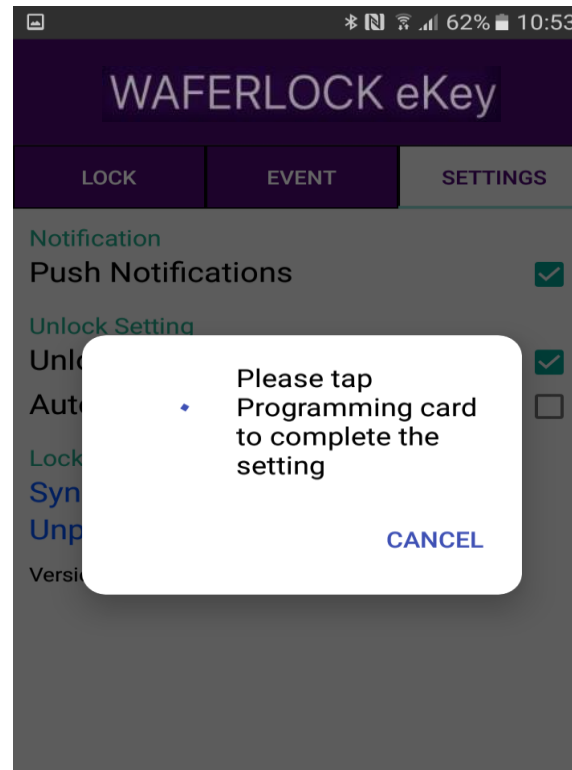
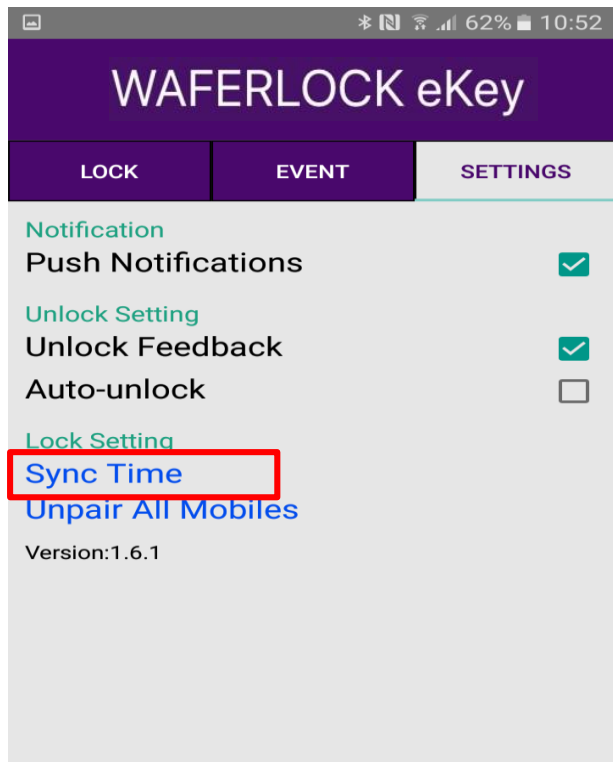

Present programming card 5 second to enter the setting mode (Same as pairing mode)

Beep x3 (Bi·Bi·Bi)

·
· **5 seconds**
Long Beep x1 (Bi---
or specify on the user manual
Then press sync time

Send Virtual Key

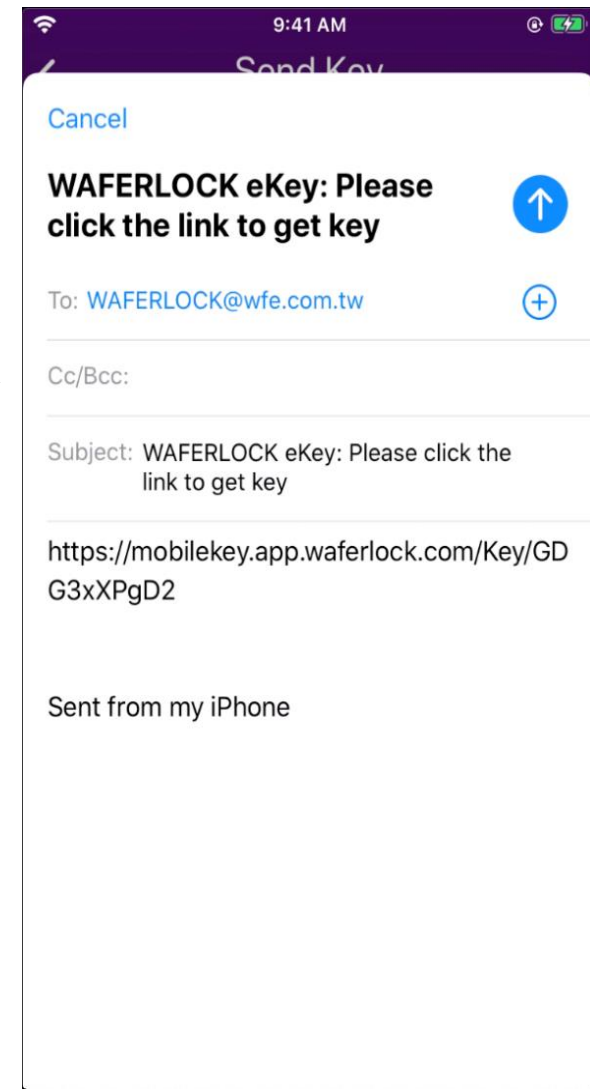
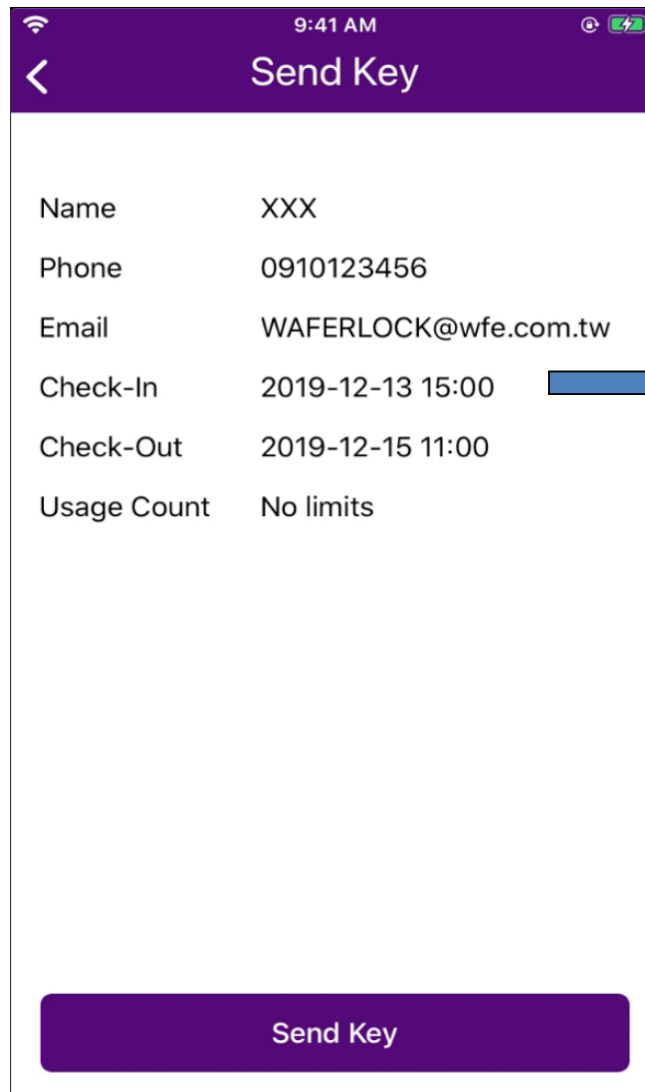
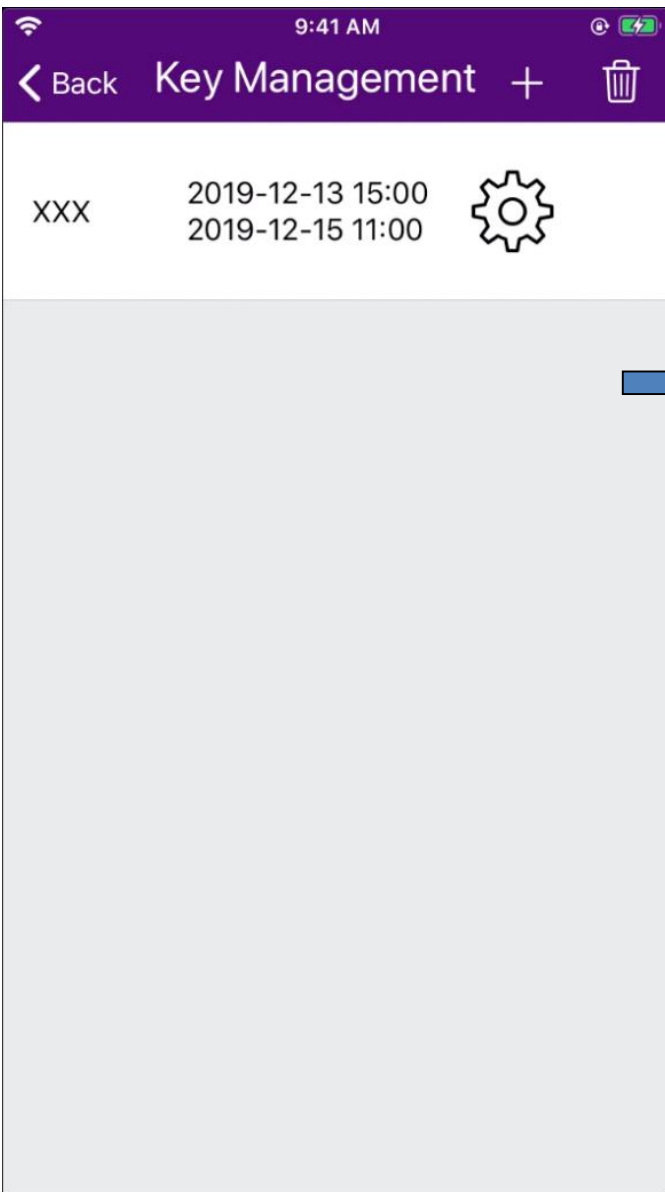

- ✘ Choose the application to send the virtual key link
- ✘ User have to download the app and register
- ✘ Click the link to receive the virtual key

Virtual Key Icon

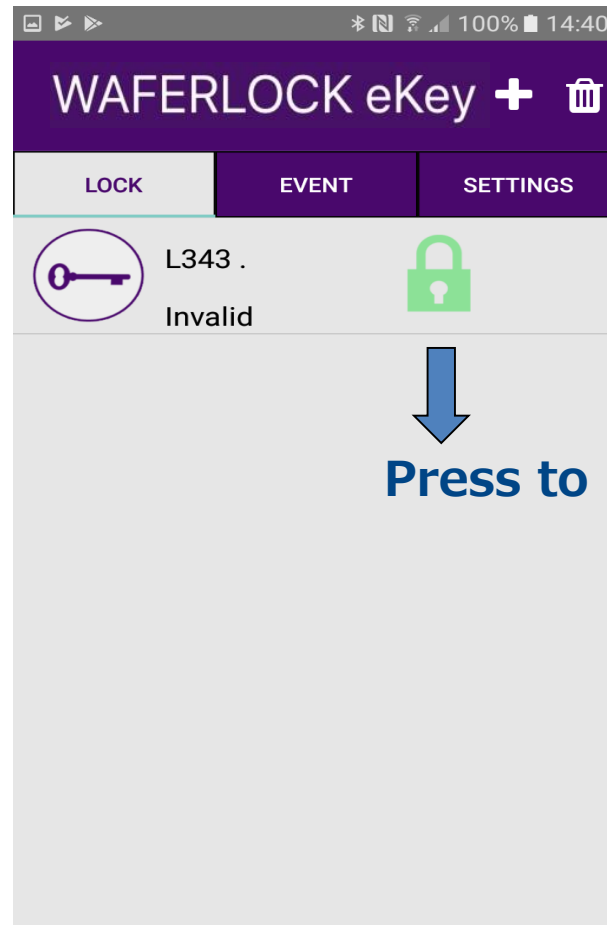

Press to unlock

Delete Virtual Key (Managed by Master Phone)

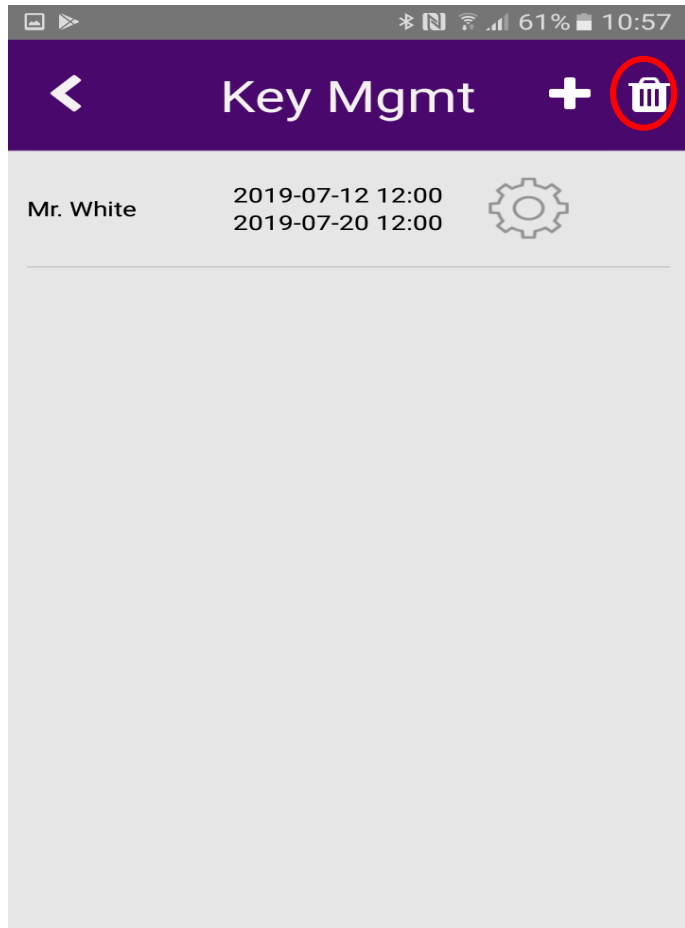

✘ Click to delete virtual key

✘ Unable to undo after the deletion

✘ After the deletion, the user's virtual key cannot be used any more

Unpair All Mobiles

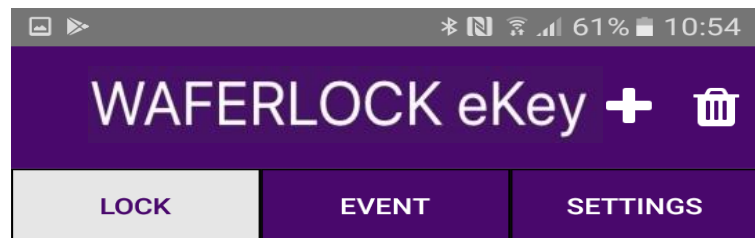

C702
Invalid



Setting →

Present programming card 5 second to enter the setting mode (Same as pairing mode)

Beep x3 (Bi·Bi·Bi)

.

. 5 seconds.

Long Beep x1 (Bi---

or specify on the user manual

Then press [Unpair All Mobiles]

Wait the message to present the programming card to complete the operation

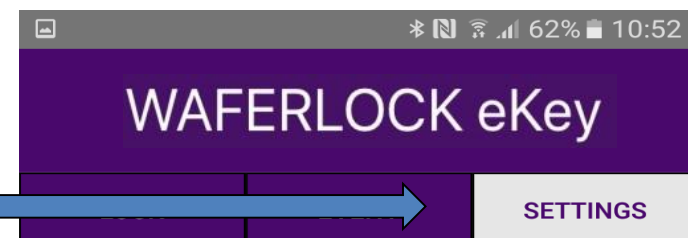

Notification

Push Notifications ☒

Unlock Setting

Unlock Feedback ☒

Auto-unlock ☐

Lock Setting

Synce Time

Unpair All Mobiles

Version:1.6.1

Unpair All Mobiles

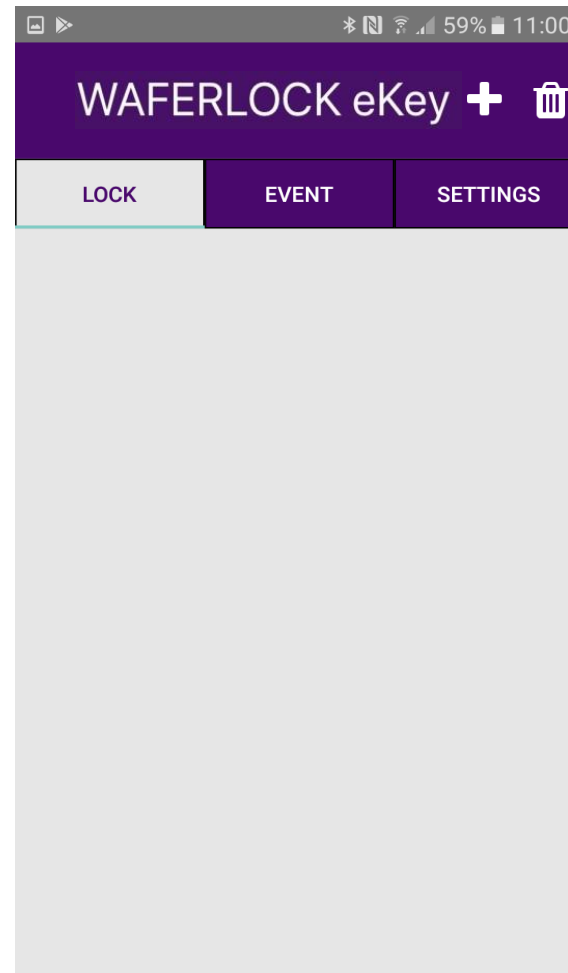
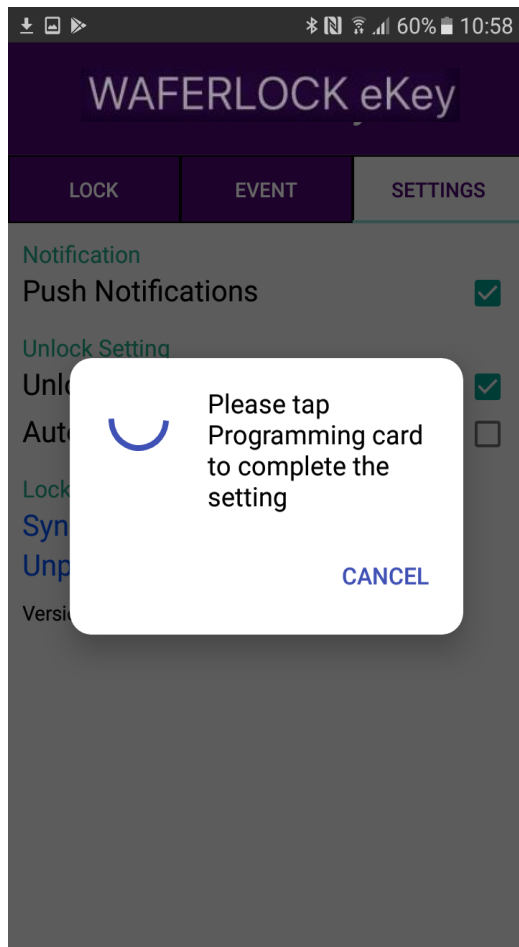

**Present programming card
No lock in the main screen**

Settings

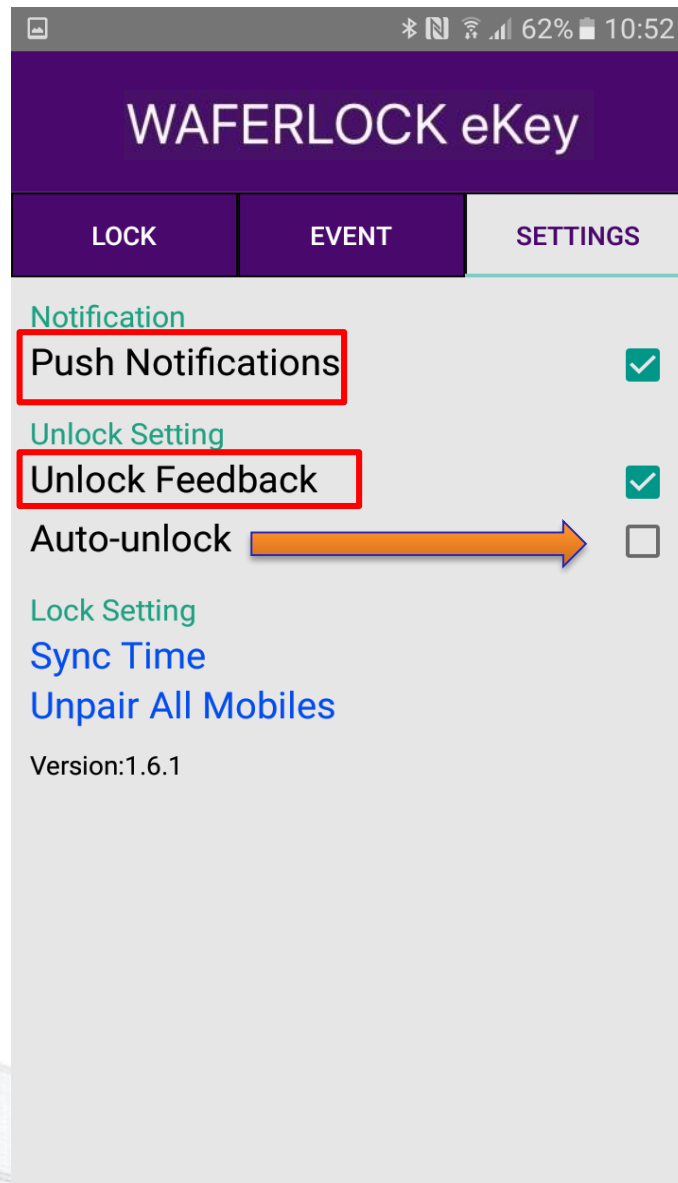

Push Notifications:
Master Phone will receive message while user use virtual key to unlock

Unlock feedback:
Vibration while unlocking

Auto-unlock:
Keeping sending unlock message

The door will auto-unlock while the user close to the lock
(Only for Andriod system now)

Contact Us

WAFERLOCK

<http://www.waferlock.com>

E-mail : info@waferlock.com

