

SW-100 Weatherproof Exit Button Installation Manual



The SW-100 weatherproof exit button adopts NEMA 4X rated enclosure and ensures strength and durability in indoor and outdoor environment.

In the case of negative pressure or vacuum, dust and moisture easily pass through the enclosure. The NEMA 4X rated enclosure protects the internal electronics from windblown dust and rain.

FEATURES

- Momentary DPDT contact
- Easy installation
- IP65 rated housing

SPECIFICATIONS

| | |
|---------------------------|----------------------|
| Model | SW-100 |
| Switch Type | Momentary, DPDT |
| Contact Rating | 6A/125VAC, 3A/250VAC |
| Operating Temperature | -20~+70°C |
| Ingress Protection Rating | IP65 |
| NEMA Rating | 4/4x/13 |

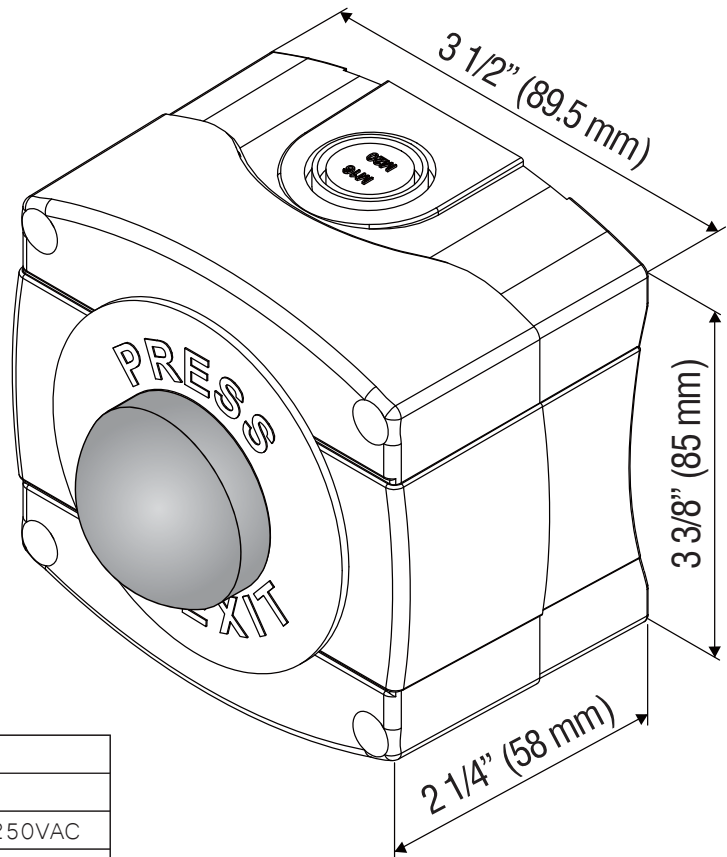

APPLICATION

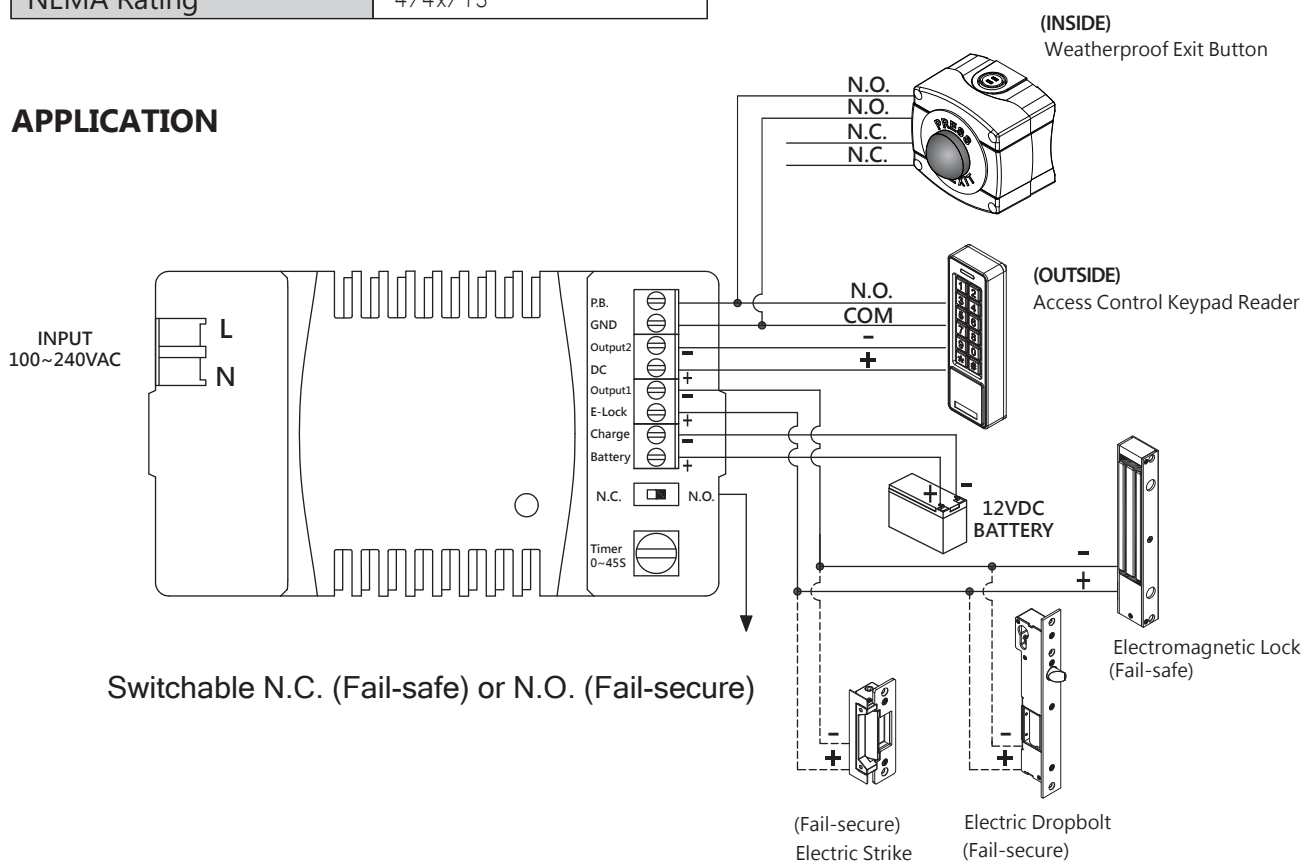

INSTALLATION DIAGRAM

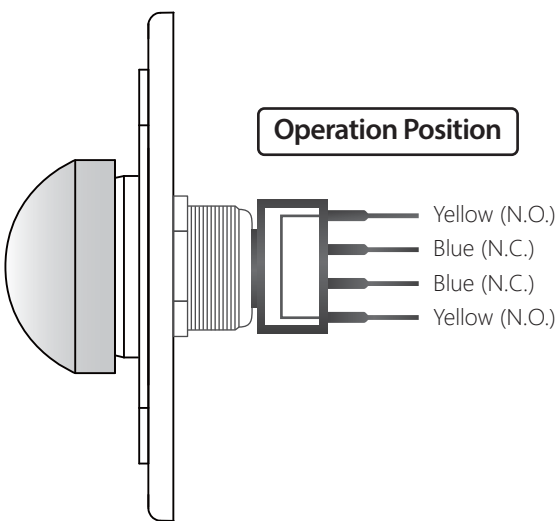
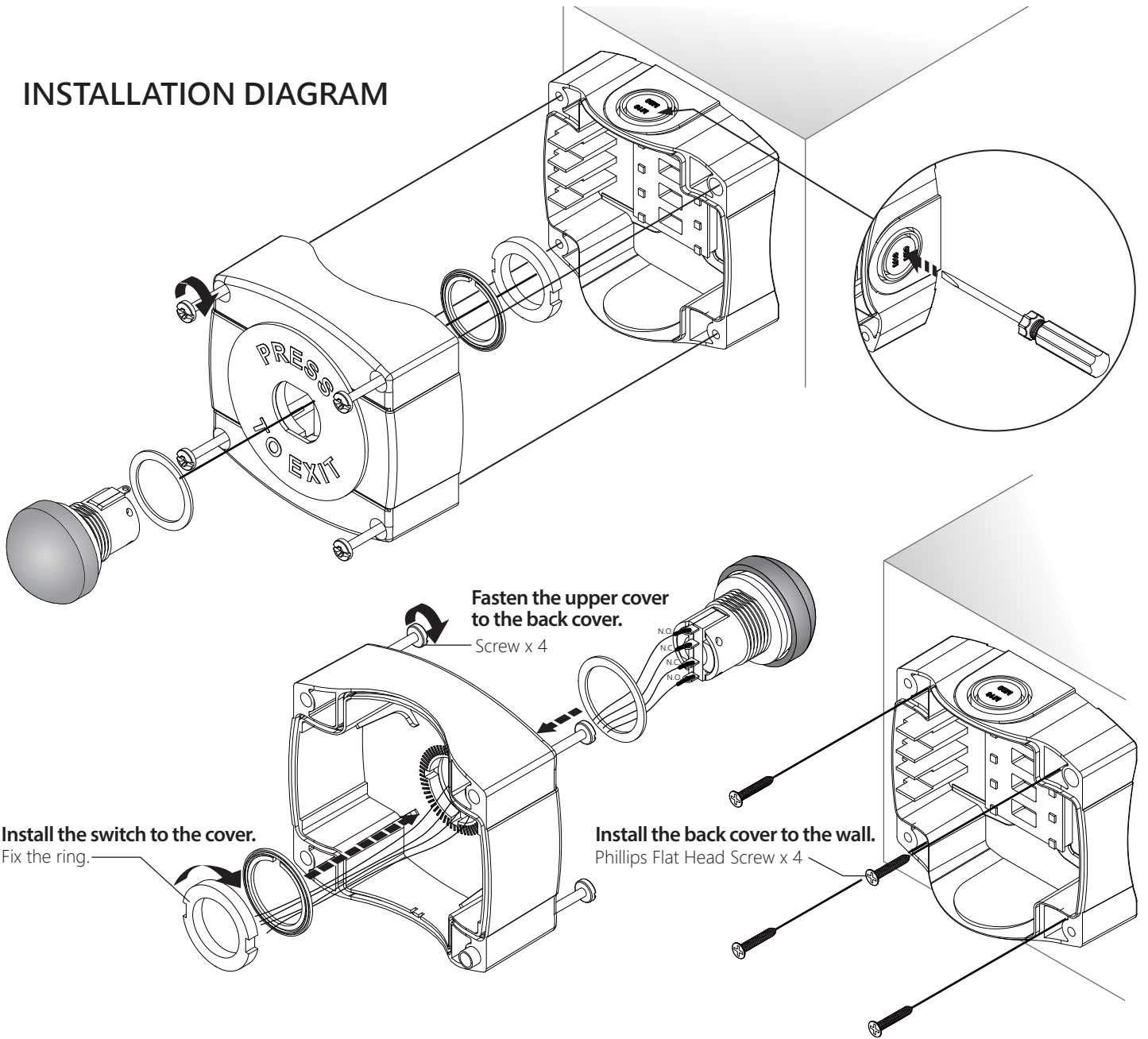

Butt Splice (IDC) Connector

Using crimper or pliers and pressing the header of connector down to even position